

VALIDO SOLO PER
VERSIONI SPECIALI

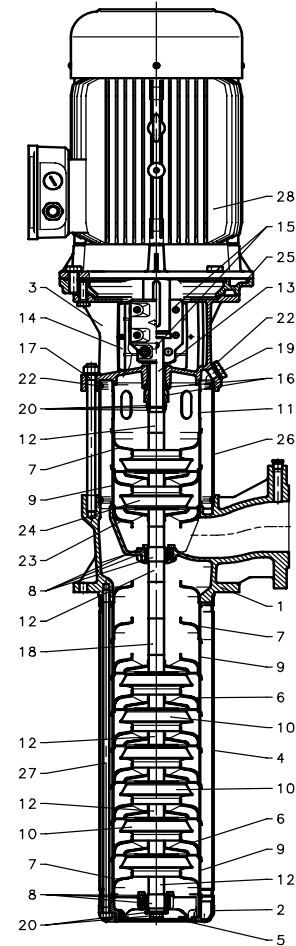

VALIDO SOLO PER
VERSIONI SPECIALI

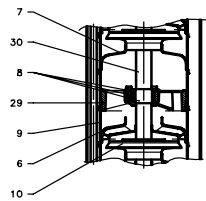
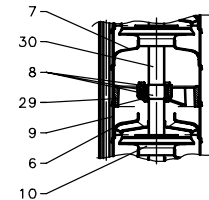

LEGEND FOR WRITTEN : VALID ONLY FOR SPECIAL VERSIONS

ITEM N	DESCRIZIONE	DESCRIPTION	Q.TA' Q.TY	CODICE - CODE											
				SVI3001/08N	SVI3002/08N	SVI3003/08N	SVI3004/08N	SVI3005/08N	-	-	-	-	-	-	
				10244401H	10244402H	10244403H	10244404H	10244405H	-	-	-	-	-	-	
				SVI3001/11N	SVI3002/11N	SVI3003/11N	SVI3004/11N	SVI3005/11N	SVI3006/13N	SVI3007/13N	SVI3008/13N	SVI3009/13N	SVI3010/13N	SVI3011/14N	SVI3012/15N
				10244401L	10244402L	10244403L	10244404L	10244405L	10244406N	10244407N	10244408N	10244409N	10244410N	10244411P	10244412Q
				SVI3001/14N	SVI3002/14N	SVI3003/14N	SVI3004/14N	SVI3005/14N	-	-	-	-	-	-	-
				10244401P	10244402P	10244403P	10244404P	10244405P	-	-	-	-	-	-	-
				3 kW	4 kW	5.5 kW	7.5 kW	11 kW	15 kW			18.5 kW		22 kW	
1	Bocca di mandata	Delivery outlet	1	151402650			151402660			151402680					
2	Fondello di aspirazione	Suction bottom cover	1	161408140											
3	Lanterna	Adaptor	1	161452811											
4	Camicia inferiore - 8 stadi	Lower sleeve - 8 stages	=>	1-166441340											
	Camicia inferiore - 11 stadi	Lower sleeve - 11 stages	=>	1-166441370											
	Camicia inferiore - 14 stadi	Lower sleeve - 14 stages	=>	2-166441390 (anello unione 168601640 non incl., connecting ring 168601640 not incl.)											
5	Filtro	Strainer	1	164600730											
* 6	Diffusore destro	Right diffuser	=>	152801220											
				1	2	3	4	5	4	5	6	7	8		
7	Coperchio diffusore	Diffuser cover	=>	Q2 - 164001730						Q3 - 164001730					
8	Kit cuscinetto N-B 8-11-14 stadi B	Bearing kit N-B 8-11-14 stages B	=>	148992210											
				2/2/3											
										3					
9	Distanziale diffusori	Diffuser spacer	Q	162502310											
* 10	Girante destra	Right impeller	R	150702240											
				1	2	3	4	5	4	5	6	7	8		
11	Distanziale finale	Final spacer	1	162502290											
12	Distanziale girante	Impeller spacer	=>	162502430											
				1	2	3	4	5	9	10	11	12	13	14	15
13	Albero N-B 8-11-14 stadi	Shaft N-B 8-11-14 stages	1	165042760/165042770/165042775											
	Albero B	Shaft B								165042730					
14	Protezione giunto	Coupling guard	2	164206580			164206590								
15	Kit semigiunti	Pair of couplings kit	1	148992390			148992400			148992410			148992420		
* 16	Tenuta meccanica	Mechanical seal	1	002232570											
31	Disco portatenuta	Seal holding disc	1										150101590		
17	Tirante	Tie rod	4							167103480			167103490	167103500	
	Dado M16	Nut M16								002617888					
18	Distanziale sostit. girante	Spacer replacing impeller	Q1	162502460											
19	Tappo carico (+ OR)	Fill plug (+ OR)	1							140170250					
* 20	Kit blocc. pacco giranti	Fixing impeller pack kit	1	148992160											
* 22	OR	OR	- 2												
* 23	Diffusore sinistro	Left diffuser	=>	002221691											
										152801230			3	4	
* 24	Girante sinistra	Left impeller	L	150702250											
										2			3	4	
25	Flangia per raccordo	Flange for connection	1							161050590					
26	Camicia superiore	Higher sleeve	1							166406920			166406930	166406940	
27	Tirante + dado M12	Tie rod + nut M12	4 + 4	167103430 + 002630710											
										167103460 + 002630710					
										167103470 + 002630710					
28	Motore trifase (T)	Three phase motor (T)	1	107106255	107106329	107106337	107106347	107106397	107106421			107106431		107106447	
	Tipo	Type		LM100RB14/330	LM112RB14S1/340	LM132RB5/355	LM132RB5/375	LM160RB5/3110	LM160B5/3150			LM160B5/3185	LM180RB5/3220		
** 29	Supporto boccola sald. N-B 8-11-14 stadi B	Bushing support N-B 8-11-14 stages B	=>	151402690											
				1/1/2											
** 30	Distanziale per supp. spec. N-B 8-11-14 stadi B	Spacer for special support N-B 8-11-14 stages B	=>	162502760											
				2/2/3											
				2											

* Parti di ricambio consigliate - Recommended spare parts

 Q = N. stadi / stages
 Q1 = Q - (L+R) - 2 ; Per N-B / For N-B => 14 stadi/stages, Q1 = Q - (L+R) - 4
 Q2 = Q - (L+R) ; Per N-B / For N-B => 14 stadi/stages, Q1 = Q - (L+R) - 1
 Q3 = Q - (L+R) + 1, Per B / For B

 ** Solo Versioni Speciali - Only Special Versions:
 B = Bilanciate / Balanced , N - B = Non Bilanciate / Not Balanced